

Detached Garage Specifications for:

Name: _____

Address: _____

Legal Land Location: _____

Phone: _____ Fax: _____

Contractor: _____ Phone: _____

Specifications

Foundation (grade beam & piles) or **Slab** (Page 3)

Foundation: Yes _____ No _____

If "yes" supply site specific drawings stamped by a Structural Engineer

If "no" provide the following:

Slab dimensions: _____ wide x _____ long

Slab thickness overall _____ perimeter _____ (See page 3 for detail)

Type of base _____

Walls

Size & spacing of studs: _____

Size, type & spacing of anchor bolts: _____

Wall/building height to eave: _____ Type of siding: _____

Thickness & type of wall sheeting: _____

Insulation & barrier: Yes _____ No _____

Inside finish: _____ None _____

*Size of each vehicle door: Door #1 - Opening width _____ & Header size _____ ply of 2" x _____

Door #2 - Opening width _____ & Header size _____ ply of 2" x _____ Door #3 - Opening width _____ & Header size _____ ply of 2" x _____

*Size of windows/man doors & header: 1. - Opening width _____ & Header size _____ ply of 2" x _____

2. - Opening width _____ & Header size _____ ply of 2" x _____ 3. - Opening width _____ & Header size _____ ply of 2" x _____

**Note door/window openings on attached sketch, page 2.*

Permit # _____

Town/Village/RM of _____

Date: _____



Professional Building Inspections, Inc.

Roof

Engineered trusses by: _____

Spacing of trusses: _____ & overhang: _____

Type of shingles: _____

Ceiling finish: _____

Insulation: _____

Other

Heating: _____

Electrical: _____

Pit or Hoist: _____

Recommend eavetroughs and downspouts

Site Plan (on the reverse side show the following):

1. Lot dimensions & lot shape
2. Garage location and set backs from lot lines
3. All existing buildings, their dimensions & distance to garage.
4. Location of easements, retaining walls & driveways

Roof Layout

Indicate the location & *size of all doors and windows* and the direction of the roof peak in the drawing below:

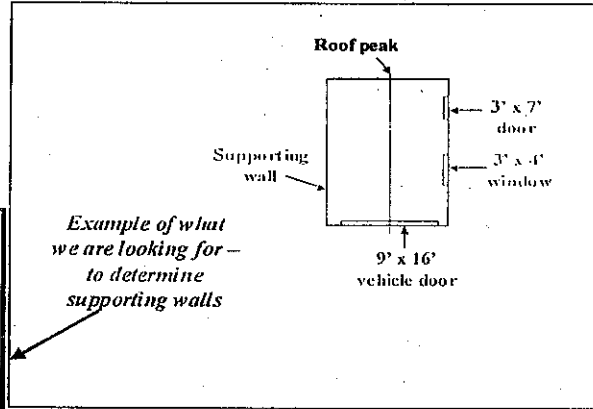
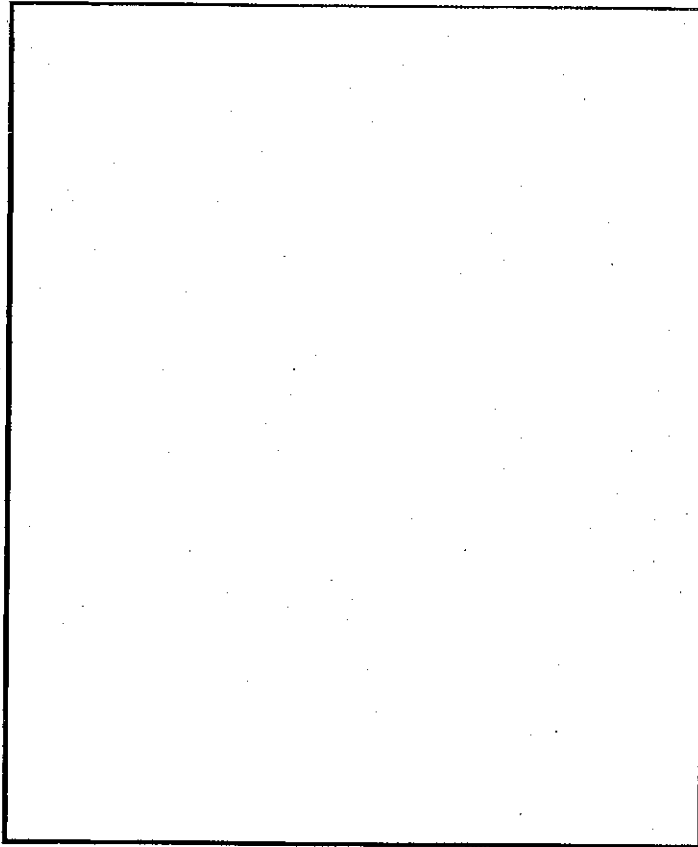

Professional Building Inspections, Inc.

Note: venting & attic hatch required if insulating

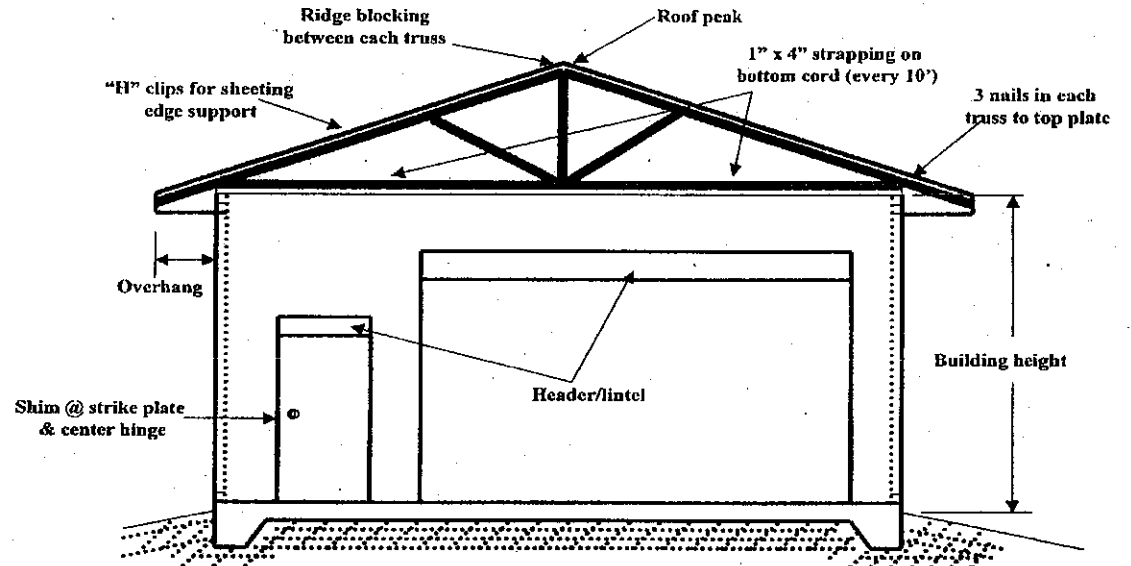

Recommended Reinforced Thickened Edge Concrete Slab



Professional
Building
Inspections, Inc.

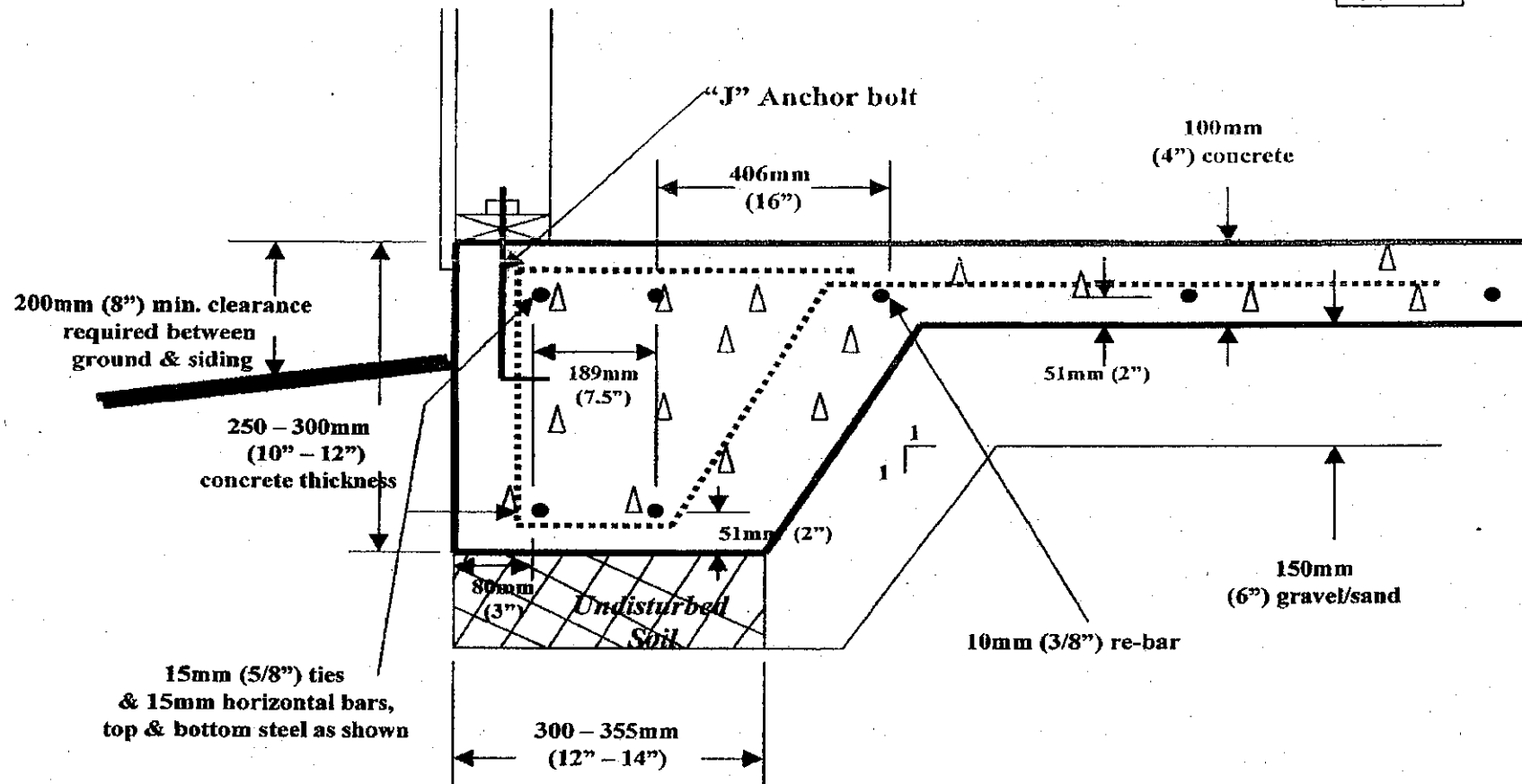

Notes:

1. 102mm (4") thick reinforced concrete slab with 10mm (3/8") dia re-bar at 406mm (16") on center each placed on:
 - 1a. 6 mil poly cover and (as per CGS B51.34M)
 - 1b. 152mm (6") deep compacted gravel base.
2. Around the perimeter place 12.7., (1/2") x 203mm (8") anchor bolts or equivalent at 900mm (36" to 48") spacing